

Technical specification

Rated working voltage	12V or 24V
Limit working voltage	9 - 26V
USB1 output	5V/1A
USB2 output	QC3.0
Working Temp.	<60°C
Music format	MP3
TF Card	1G - 32G
Bluetooth Version	4.2+EDR
Modulation system	QPSK
DAB Freq.	177MHz - 240 MHz
Auto power-off memory	Yes
FM Freq.	87.5MHz - 108MHz
Emission Distance	0.5 - 2M
Bluetooth emission distance	Less than 10M

Accessories

1. Main body
2. Manual
3. Antenna
4. 3.5mm audio cable

In-Car DAB Radio Adaptor With Bluetooth



WARRANTY: To validate the warranty on this product, please go to our website and enter your details on the warranty screen. www.streetwizeaccessories.com



Streetwize Accessories:
 Unit 1, Royce Trading Estate, Ashburton Road West,
 Trafford Park, Manchester M17 1RY

Sales enquiries: sales@streetwizeaccessories.com
Technical enquiries: support@streetwizeaccessories.com
 +44 (0) 161 447 8597
www.streetwizeaccessories.com

Production introduction

This car kit is the car digital audio broadcasting, adopts the professional high-performance digital broadcasting processor; built-in encoding, modulation and transmitting the DAB signal to the car audio system; It is an multi-functional device which can charge your mobile phone, bring the customer with better intelligent experience!

Please read these instructions carefully before operating this product and retain for future reference.



Schematic Diagram of Product

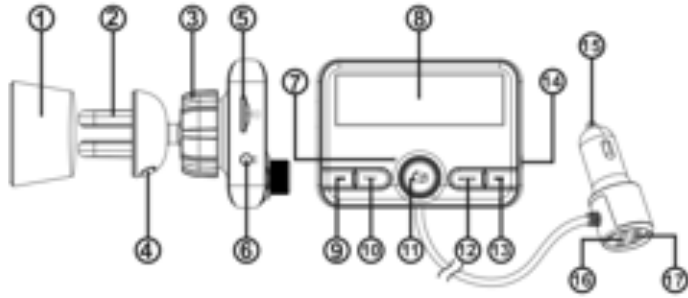

1. Centre console fixed leg
2. Air vent clip
3. Rotary shaft setting
4. Clip adjust place
5. TF card slot
6. Audio output
7. MIC
8. LCD display
9. Previous button
10. CH ≠activation/DAB automatically searching
11. Answer/Play/Volume adjustment
12. Mode shift (DAB/Bluetooth/TF card)
13. Next button
14. Antenna jack
15. Power adaptor
16. USB output: 5V/1A
17. USB output: QC3.0

Product Features:

1. Support full FM Frequency 87.5MHZ-108MHZ
2. Auto power-off memory function
3. Support quick charging QC3.0
4. LCD display
5. Support QPSK
6. DVB Freq.177Mhz--234Hz, sound quality like from CD
7. Support TF card
8. Support answer, reject, hang up, redial through Bluetooth
9. Audio output

Operation Guide

Plug charger into car cigarette lighter and the DAB will be power on; Plug antenna into antenna port of this device and fix another end on the front window of car.

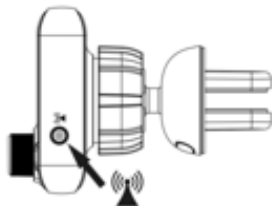

Step 1:

Detach the white protective paper from the black film. Tear off the protective paper on the transparent film. Discard the two protective papers.

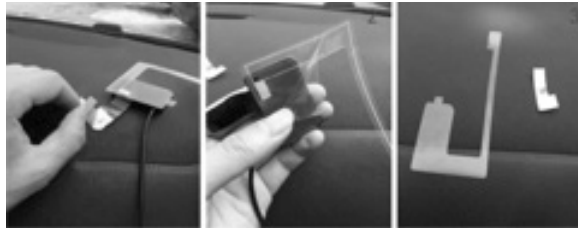

Step 2:

Paste the black film on the metal of pillar A and transparent film on glass and pay attention to reserve installation position for plastic gusset plate.



Step 3:

Stick the black film and transparent firmly, fix the cable strongly.



Step 4:

Install back of the plastic gusset on the pillar A and attention to protect the black film from broken, then installation is finished.

FM frequency channel search

Long press **TX** and enter channel search. Long press **⏪** enter to decrease frequency quickly, short press to decrease slowly. Long press **⏩** enter to increase frequency quickly, short press to increase slowly. Adjust frequency from 87.5 to 108MHZ and exist to main menu after confirm the channel if there is no operation in five minutes.



Channel searching on DAB mode:

Press TX button to search for channel and display the channel quantity.

- ⏪** : select the last channel.
- ⏩** : select the next channel.



Hands-free

1. Press Mode to enter BT mode
2. Pairing your mobile device with the DAB by Bluetooth when you use in the first time. Set the Bluetooth on in mobile phone and search for pairing name on In-Car DAB Radio and select it. There is a prompt tone after paired.

Bluetooth mode

1. Mode: DAB/BT/TF mode shift: **⏪** answer key.
2. Short press to answer
3. Short press to hang up under talking
4. Long press to reject when call is coming
5. Double press to last call
6. **⏪** Play the last song in phone
7. **⏩** Play the next song in phone
8. Music play status: Play/Pause



TF card mode

1. Plug in the TF card according to the director of TF card painting and insert it in place
2. Switch to TF mode
3. **⏪** : Play/Pause
4. **⏪** : Last song
5. **⏩** : Next song

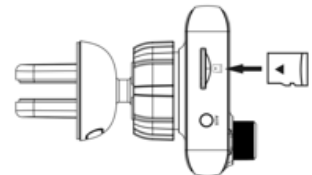

Audio output

Plug one end of audio cable with 3.5MM pin into output port of this device and another end to input port on car speaker.

