



# Solar-Powered Imperial Bird Bath Fountain

*With Back-Up On-Demand Lithium Battery*

SWGSL276

## Information For Use



*To get the best use of this water feature, we highly advise that you read all the information and safety guidelines in this document.*

# Contents

1. Gardenwise Solar-Powered Imperial Bird Bath Fountain (sprinkler bowl, reservoir bowl & base)
  2. Built-in LED lights
  3. Solar panel/sprinkler with built-in lithium battery
  4. Water pump
- 

## Positioning This Solar-Powered Water Feature

When placing this water feature, ensure the solar panel is placed where it can get the most direct sunlight.

Avoid positioning the solar panel in an area where there is a lot of shade as this will affect the performance.

---

## Assembly Instructions

1. Remove the product from its packaging
2. Place the water feature in a location where the solar panel can receive plenty of direct sunlight.
3. Connect the water pump to the reverse side of the solar panel/sprinkler unit using the supplied water tube (see figure 1).

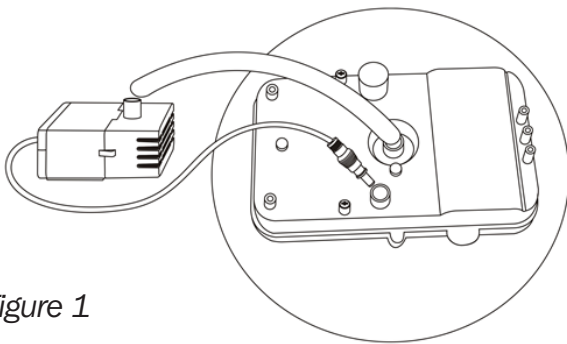

Figure 1

4. Then assemble the bird bath fountain as shown in figure 2. When placing the solar/sprinkler unit, ensure the connected water pump is inside the sprinkler bowl and placed at the bottom

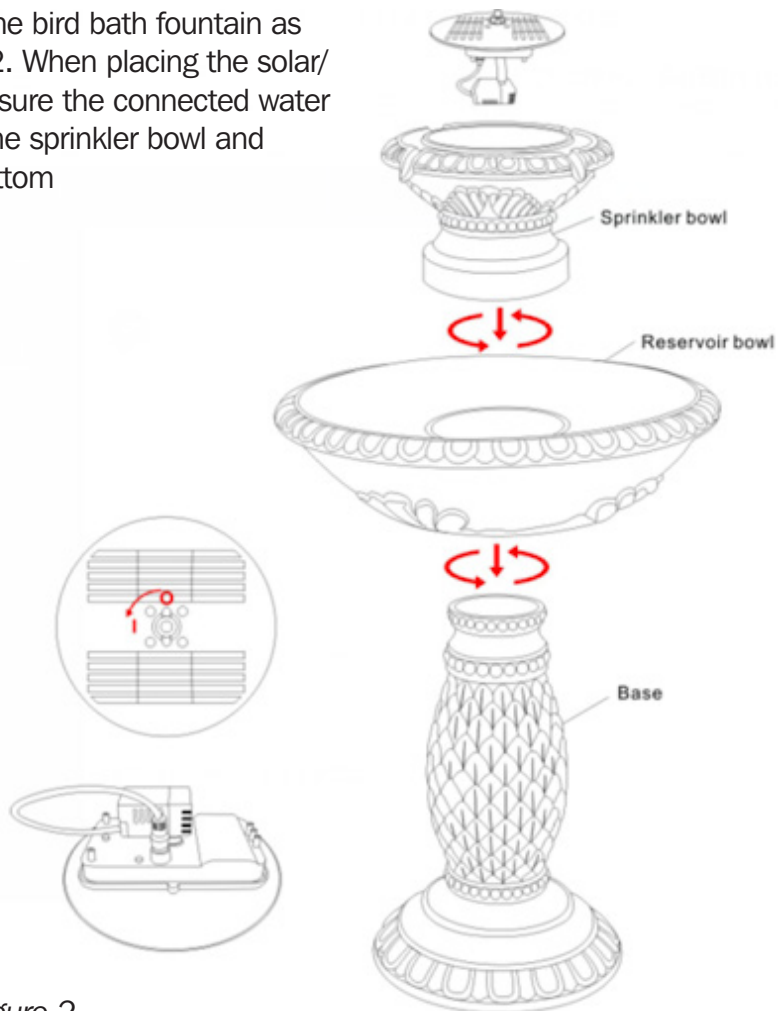

Figure 2

5. Fill the basin with water up to an appropriate level (up to an inch below the edge). Ensure the water pump is immersed in the water.

## On First Use

The built-in back-up lithium battery in this product will have been 70-80% charged upon manufacture. However, on the date of purchase, the battery will lose its charge during shipping and storage. For best results, allow the solar panel to charge the battery for a full day in direct sunlight before using the pump.

---

## Direction for Use

This water feature is designed to run during the day in direct sunlight. Any excess power produced via the solar panel will be used to charge the back-up battery. This will allow for running of the pump and LED light in the evening. Please note, the evening runtime will vary depending on charge level of battery and weather conditions.

The LED light automatically illuminates in the evening, if there is sufficient charge in the battery.

## How to Turn On The Unit

---

To turn on the unit to start running the pump and the LED light, turn the switch to the “1” position for it to turn on. The switch is located at the top of the solar/sprinkler unit (see figure 3).

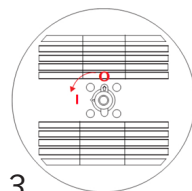

Figure 3

## How to Charge The Lithium Battery

---

To switch off the pump, turn the switch to the “0” position. When the pump is switched off, all of the charge generated by the solar panel will be stored in the back-up battery.

Please note, this may have to be done periodically during inclement weather.

## Cleaning and Maintenance

### Pump

---

If the pump stops working or is running slow, you will need to disassemble and clean the pump to remove any debris/limescale from the filter and motor chamber, as shown in Figure 4.

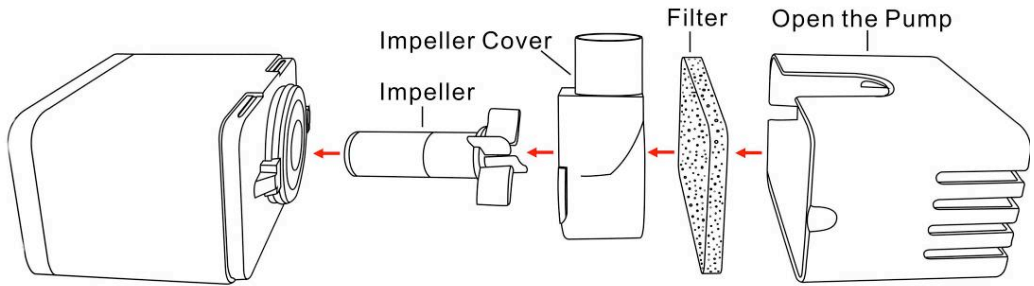

Figure 4

To disassemble the pump, ensure the unit is switched off. Remove the pump from the water tube and take the pump out of the water. Then, remove the pump cover, filter and impeller cover (figure 4). Clean them with fresh water and place them back inside the pump.

### Solar Panel

---

The solar panel should be cleaned with a soft cloth on a regular basis to maintain an optimum efficiency.

### Safety Warnings

---

1. For safety reasons, please do not remove or change any components in the bird bath. Doing so will invalidate your guarantee.
2. Do not connect pump to AC power source. It is only for use with DC power.
3. Use fresh water only
4. Do not use with flammable liquids
5. Take care not to damage the solar panel
6. Do not use in water above 35°C
7. Do not let the pump run dry

### Storage

Ensure the battery is fully charged before storing and disconnecting all cables. We recommend the use of a cover to protect the water feature from dust/damage.

# Troubleshooting

<b>Troubleshoot</b>	<b>Potential Cause</b>	<b>Pump Run Time</b>
Pump not operating under full sunlight.	Pump is not connected to the solar panel. Impeller is blocked - to clean the pump, remove the front plate and the impeller. Use a small brush or fresh water to remove any debris.	Check connection to the solar panel. Remove blockage (see cleaning and maintenance).
Pump is operating but water is not running through the fountainhead.	Build-up of sediment or limescale inside the pump.	Clean tubes and filter (see Cleaning and Maintenance)

# Pump Performance In Different Weather Conditions

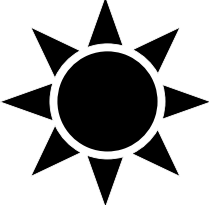
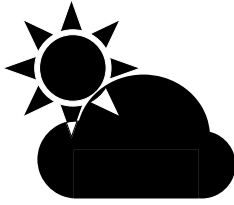
<b>Weather</b>	<b>Pump On</b>	<b>Pump Off</b>
	Solar energy runs the pump and charges the battery. Pump performance is maintained when brief cloudy conditions occur. Pump runs up to 5 hours in the evening.	Battery should be fully charged in 1 day.
	Solar energy runs the pump and supplies some energy to the battery. Performance is maintained when the clouds pass. Pump will only run a shorter period of time in the evening.	Battery will take 2 to 3 days to fully charge.

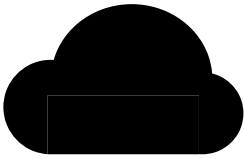

Pump will only run when there is sufficient power from the battery. Little or no battery charging occurs so pump performance is not maintained.

Battery will take several days to fully charge.

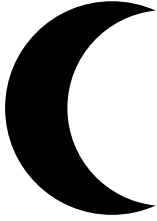

No solar power is available, the pump will not run and battery will not charge.

Battery will not charge.

---

## Technical Specification

Product	Gardenwize Solar-Powered Imperial Bird Bath Fountain
Supplier Code	SWGSL276
Solar Panel	1.4W
Operation Voltage	6V DC
Water Flow Max	200LPH
Water Lift Max	0.6M
LED Light	4 LED light - white
Cable Length	5M
Lithium Battery	3.7V-2000 mAh

---

**Streetwize:** Ashburton Road West, Trafford Park, Manchester M17 1RY

---

**For Product Support:**

**E:** [support@streetwizeaccessories.com](mailto:support@streetwizeaccessories.com)

**T:** +44 (0)161 447 8597

**For Trade Enquiries:**

**E:** [sales@streetwizeaccessories.com](mailto:sales@streetwizeaccessories.com)

**T:** +44 (0)161 447 8580

---

**[www.streetwizeaccessories.com](http://www.streetwizeaccessories.com)**

---