

streetwize
ACCESSORIES

streetwize
ACCESSORIES

Charging smart phones etc:

1. Insert the USB charging plug into the 5V 2.1A USB output port.
2. Insert the correct adaptor for the device to be charged.
3. When the cable is connected Press the "On" button to charge the device.

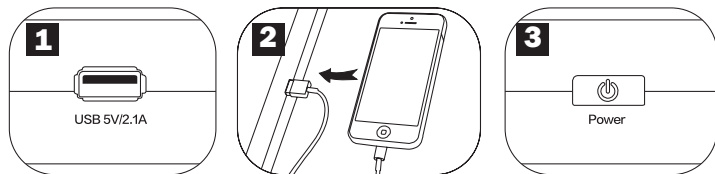

Charging the Emergency Jumpstart & Powerbank:

1. Insert either the 12V In-car charger or 240V mains power cable into the 15V/1A input port on the unit.
1. Insert the plug end into the require power socket. The LED's (blue) will flicker to indicate charging, 5 lit LED's will indicate a FULL charge.

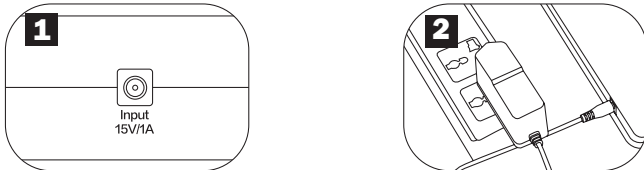

The WEEE symbol  on this product means that this product should be ethically dismantled or recycled to minimise environmental impact. Please check with your local authority for more information.

IMPORTANT: ADDITIONAL SAFETY INFORMATION: This Jumpstart & Powerbank is **NOT** intended for use by persons (including children) with reduced physical, sensory or mental capabilities, or lack of experience and knowledge, unless they are supervised or have been given instruction concerning use of the Jumpstart & Powerbank by a person responsible for their safety.



Streetwize Accessories: Sales enquiries: sales@streetwizeaccessories.com
Technical enquiries: support@streetwizeaccessories.com www.streetwizeaccessories.com

Next Generation Portable

Emergency Jumpstart & Powerbank **12V - 400Amp**

A **POWERFUL** but compact **400Amp-(peak)** emergency Jumpstart for most 12V vehicles. **PLUS** a Power Bank that also provides **HOURS OF PORTABLE POWER** for smart phones, laptops, or tablets and much more when out and about!

Please read these instructions carefully before operating this device.

It is recommended to charge the unit for 3 hours before any use.



Emergency Jumpstart & Powerbank contents:

- Emergency Jumpstart & Powerbank
- 12V battery clips
- USB charge cable with 4 built-in assorted adaptors.
- 240V mains plug.
- 12V in-car charging plug.
- interchangeable power lead with 8 adaptors.







Emergency Jumpstart Operating Instructions:

generally a vehicle can be jump started with only 2 power LED's (blue) lit on the unit, however it is preferable to use a fully charged unit. **DO NOT USE THE CHARGER WITH LESS THAN 2 LED's LIT**

1. Connect the crocodile clips in the following order. Positive (+ Red) charging lead to the positive (+ Red) terminal. Connect the negative (- Black) charging lead to the negative (- Black) terminal. It is important that the crocodile clips are making good contact with the battery terminals.
2. Connect the crocodile clips into the Jumpstart power outlet.
3. Turn the key to start the vehicle engine. If the engine does not start immediately turn off the engine, wait at least 15 seconds.
4. When the vehicle starts, unplug the power supply plug from the unit and remove the crocodile clips from the battery.

Caution: Never connect the red & black crocodile clips together.

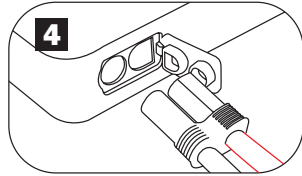
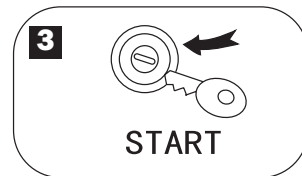
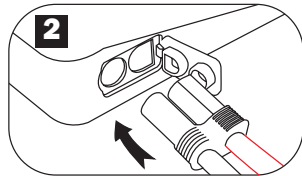
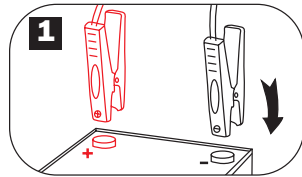
Always use the charger at normal room temperature, never use near a naked flame. Store in a cool dry place



Charging Instructions:

The unit has multiple charging outputs 12V & 19V. Press the power on button (1) to select the required voltage, the LED's (2) will light to show the chosen voltage. Laptops and larger gadgets generally require a 19V power supply.

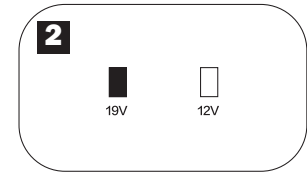
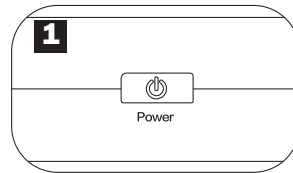

Charging laptops etc:

1. Insert the 12V in-vehicle or 240V mains power lead into the output power point of the unit.
2. Choose the correct connector to connect the laptop or other device to the unit.
2. Insert the correct connector onto the power lead and connect the device to the powerbank unit. Press the "On" button.

